

# TRUE NORTH ADVENTURE

## OUR NEW PROGRAM FOR THE 2025-2026 ACADEMIC YEAR

True North Adventure is a three day, faith-based, outdoor experience for students of all ages. Each morning you'll gather with other schools for devotions before heading out to your school's self-guided Activity Blocks or an Adventure Programming Activity. In the evening, you'll rejoin other schools for an inspiring message and uplifting time of worship.

With True North, your group can focus on the activities most important to you and can move at your own speed, lingering on areas of interest for your students.

We're revamping our course materials to be simple to use and easy to understand for all learners with the help of customized Guidebooks. The Guidebooks empower your leaders to direct each Activity Block and each activity includes a faith-based debriefing section to connect learning to your student's walk with God.

### Dates:

- o Sept 24-26 - Grades 6-9
- o Oct 8-10 - Grades 9-12
- o Nov 5-7 - All Grades
- o Mar 18-20 - All Grades
- o Apr 15-17 - Grades 6-9
- o May 13-15 - Grades 9-12

### Courses Include:

- o Pond Ecosystem
- o Slingshots
- o Archery
- o Basic Compass
- o Challenge Initiatives
- o Fire-building
- o Geocaching
- o Hikes (Waterfall, Swamp, Creek)

### Adventure Programming:

- o Laser Tag
- o NEW High Ropes Course
- o Climbing Wall

### Sample Curriculum - Hike:

Using the provided maps and guide materials, make your way along one of our marked trails. Along the path, you'll find colorful placards which correspond to material in your Guidebook. The Guidebook is full of information on flora, fauna, and the special features of each hike.

## CONTACT

For additional information or to book True North Adventure for your group, please reach out to Liz Reichart, Youth Ministries Office Manager.

✉ [truenorth25@sprucelake.org](mailto:truenorth25@sprucelake.org)

☎ 570-595-7505 ext. 151

## DAY 2 SAMPLE SCHEDULE

Breakfast Time  
Devotions and Announcements  
Activity Block & Adventure Programming  
Free Time  
Lunch Time  
Group Meeting  
Activity Block & Adventure Programming  
Activity Block & Adventure Programming  
Dinner Time  
Evening Worship  
Large Group Recreational Activity

# TRUE NORTH ADVENTURE

## PRICING: 2025 - 2026 ACADEMIC YEAR

True North Adventure is a three day, faith-based, outdoor experience for students. Hosted on our beautiful 10 million dollar campus, True North serves schools and homeschool families or co-ops.

Each NEW cabin boasts a roomy layout with private bathrooms and showers making it easy for your group! Standard cabins sleep 14 guests; smaller duplex cabins sleep 6 in an accessible format.

With the exception of family groups, cabins are assigned to same gender individuals from the same school/organization. For each gender, groups will be assessed a cabin rate (standard or duplex) as well as a \$166 fee for each participant over the cabin occupancy. Additional cabins and spaces are available for overflow housing.

### Rates:

- |                                     |                 |
|-------------------------------------|-----------------|
| • Standard cabin (up to 14 people)  | \$ 2,335        |
| • Accessible cabin (up to 6 people) | \$ 1,066        |
| • Additional participants           | \$ 166 / person |

### Optional Add-On Activities

- |                         |                |
|-------------------------|----------------|
| • Laser Tag             | \$ 10 / person |
| • NEW High Ropes Course | \$ 15 / person |
| • Zipline               | \$ 15 / person |

### Rate Example:

School A has a group of 16 ladies and 18 gentlemen. They will pay the Standard Cabin rate of \$2,335 for 2 cabins (1 per gender) and an additional \$166 fee for 2 ladies and 4 gentlemen resulting in a total bill of \$5,666 or approximately \$166/person.



### Standard Cabin Floor Plan

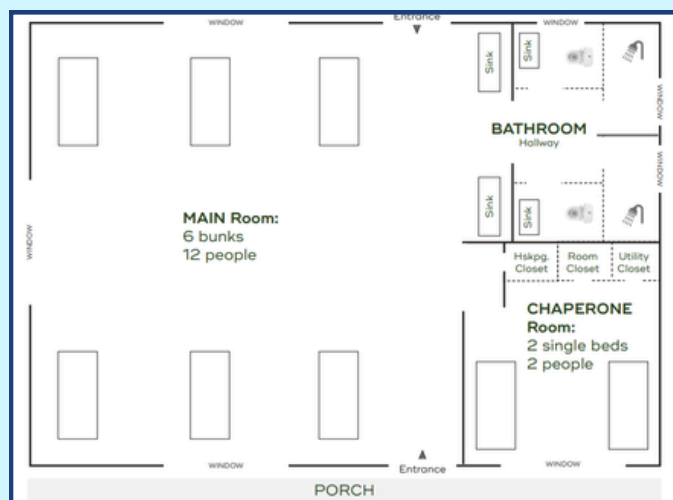

### Cost Includes:

- Six delicious meals! Wednesday dinner through Friday lunch
- Two nights' lodging at our kid-friendly youth campus.
- A dynamic evening worship experience! Our speakers and worship teams will inspire your students as they pursue Christ.
- Activity blocks in a curriculum custom designed for your students! Our Guidebooks make it easy for leaders to foster curiosity and discovery.
- Climbing Wall! Each student has the opportunity to test their skill on our 45 foot indoor climbing wall.
- An educational experience like no other! With almost 1,000 acres to explore, your students can experience God's creation at its best, here at Spruce Lake!